

EVENTS

LAGUNA NIGUEL



THE RITZ-CARLTON®

ARRIVE

In Southern California, the majestic Pacific Ocean caresses long, unspoiled stretches of beach under the gentle warmth of year-round sunshine, creating an area that attracts visitors from around the world. Perched above Salt Creek Beach is the re-imagined Ritz-Carlton, Laguna Niguel, an iconic and unique oceanfront resort that offers a limitless choice of event possibilities. Set higher meeting expectations where exciting land and water activities, including golf and surfing, abound. Sailing, deep sea fishing and whale watching are also conveniently close. The countryside invites explorations to Balboa Island, chic Newport Beach, the Temecula Wine Region and surfing thrills at Doheny Beach. For shoppers, Laguna Beach offers numerous galleries and boutiques.





RELAX

The Ritz-Carlton, Laguna Niguel provides a breathtaking locale for memorable events. From its setting atop a 150-foot bluff, the resort blends spectacular views of the Pacific Ocean and impeccable personal service. Allow our Ladies and Gentlemen to be an extension of your staff, ensuring expert assistance with all facets of your agendas, and a dedicated Conference Concierge to attend to every detail of your unique event. Let our expert staff suggest a variety of creative on-property programs; group tours and excursions; décor and themed events; and an impressive array of teambuilding activities for 10 to 500 participants.

GATHER

Amidst the beauty of garden courtyards and oceanfront lawns, the resort offers unique experiences for conference attendees. With more than 26,000 square feet of indoor meeting space, including the 9,207-square-foot ballroom and 18 additional function rooms, the resort can accommodate gatherings ranging from two to 900. 54,000 square feet of sprawling outdoor gardens, terraces and lawns provide an array of additional gathering spaces. Complementing all these amenities is an expert staff with a passion for excellence and the backdrop of the Pacific Ocean.



MEETING AMENITIES

- 26,224 square feet/2,346 square meters of indoor function space
- 9,207 square-foot/856 square-meter Ritz-Carlton Ballroom
- 18 meeting rooms
- Technology Butler® services
- High-speed Internet access
- Conference concierge
- State-of-the-art audio-visual equipment
- Catering and destination services

ROOM SIZES & CAPACITIES	square feet	square meters	dimensions (ft)	dimensions (m)	ceiling ht (ft)	ceiling ht (m)	reception	rounds of 10	theater	conference	classroom	u-shaped	hollow square
LOBBY LEVEL													
The Ritz-Carlton Ballroom	9,207	856	140x66	43x20	13	4	900	700	800	–	500	–	–
Salon I, Salon V	1,225	114	35x35	11x11	13	4	125	70	100	35	60	40	40
Salon II, Salon VI	1,173	109	34x35	10x11	13	4	100	60	90	36	60	40	40
Salon III, Salon IV	2,328	217	35x67	11x20	13	4	200	160	180	60	120	70	65
The Pavilion	3,900	363	130x30	40x90	10	3	350	250	300	–	200	–	–
Pavilion I, II, III, IV or V	780	73	26x30	8x9	10	3	50	50	40	20	30	24	32
The Pacific Promenade	4,802	446	52x82	16x25	15	4	540	330	420	180	240	–	–
Pacific Promenade I	1,522	141	52x26	16x8	15	4	180	110	140	50	80	50	55
Pacific Promenade II	1,681	156	52x26	16x9	15	4	180	110	140	50	80	50	55
Pacific Promenade III	1,599	149	52x26	16x8	15	4	180	110	140	50	80	50	54
The Promenade	1,242	116	46x27	14x8	10	3	100	70	80	40	60	38	42
The Colonnade	644	60	23x28	14x9	10	3	40	40	40	20	20	24	28
The Plaza	1,316	122	47x26	14x9	10	3	70	70	100	40	60	40	40
The Terrace Salon	4,098	1,249	50x70	15x21	10-13	3-4	200	180	140	40	90	54	60

(Rounds of 8)

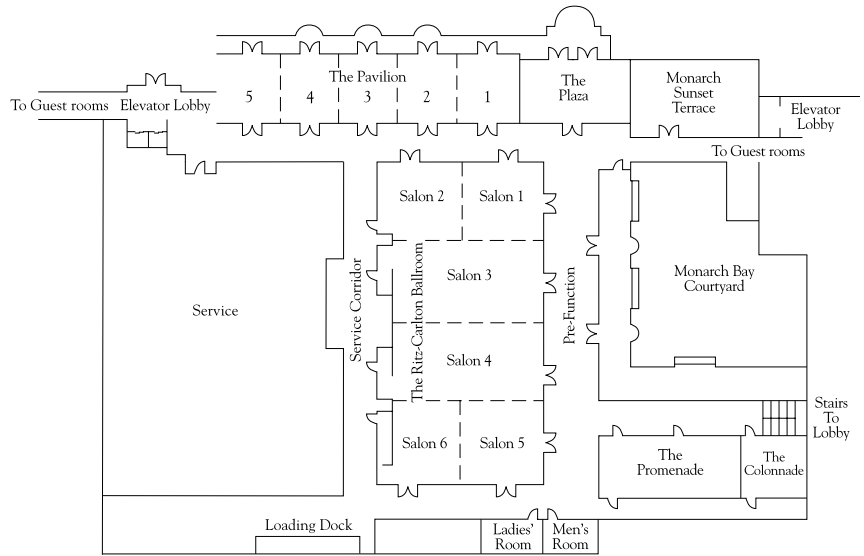
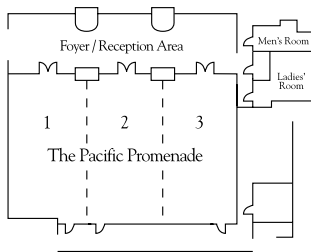
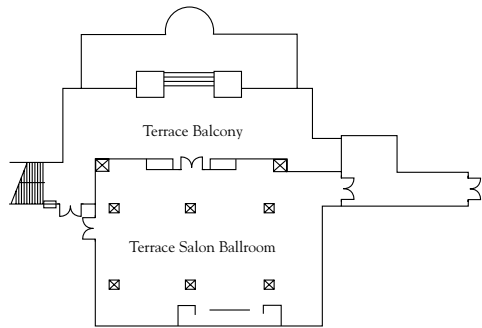

	square feet	square meters	dimensions (ft)	dimensions (m)	ceiling ht (ft)	ceiling ht (m)	reception	rounds of 10	theater	conference	classroom	u-shaped	hollow square
OUTDOOR VENUES													
Monarch Bay Courtyard	4,512	419	-	-	-	-	250	180	-	-	-	-	-
Monarch Bay Sunset Terrace	1,600	149	-	-	-	-	75	60	-	-	-	-	-
Monarch Pool Terrace	11,264	1,046	-	-	-	-	250	200	-	-	-	-	-
Gazebo Lawn	4,850	451	-	-	-	-	400	160	-	-	-	-	-
Dana Lawn	16,000	1,486	-	-	-	-	600	360	-	-	-	-	-
Dana Pool Terrace	12,800	1,190	-	-	-	-	700	420	-	-	-	-	-
Pacific Promenade Lawn	3,000	279	-	-	-	-	200	240	-	-	-	-	-
The Terrace Salon Balcony	2,270	692	-	-	-	-	100	102	-	-	-	-	-

R E S T

The 396-room hotel offers stylish accommodations expected of a resort consistently ranked among the finest in the world. With fantastic weather year-round, attendees will enjoy delightful views and experience the atmosphere, spacious gardens, and beauty of the Southern California scenery from their secluded patios or balconies. Guest room choices include 30 fireside ocean view rooms and 32 rooms on the club level. Accommodations on the club level include distinctive amenities such as complimentary food and beverage presentations during the day and evening, a secluded lounge and dedicated concierge staff. All guests relax in the luxury of down comforters and goosedown or non-allergenic foam pillows. Plush terry or lightweight robes and luxurious bath essentials are among other pampering features of each guest room. A host of added conveniences, such as wireless high-speed Internet access and an LG 42-inch LED/LCD flatscreen HD television with DVD player, will enhance the participant's in-room experience.

N O U R I S H

The resort offers event attendees an excellent array of dining opportunities, culinary expertise and unique banquet menus. When on their own, guests can relax at the oceanfront, bluff-top lounge, 180blū, boasting a magnificent 180-degree view of the Pacific Ocean. Raya showcases Pan-Latin Coastal Cuisine prepared with sustainable seafood, local produce and amazing views from floor-to-ceiling windows. enoSTEAK is an intimate steakhouse featuring grass-fed, pasture-raised beef and locally grown, organic produce. The casual Bar Raya offers fine cocktails and appetizers, and light fare is served poolside at The Dana Pool Café when seasons permit.



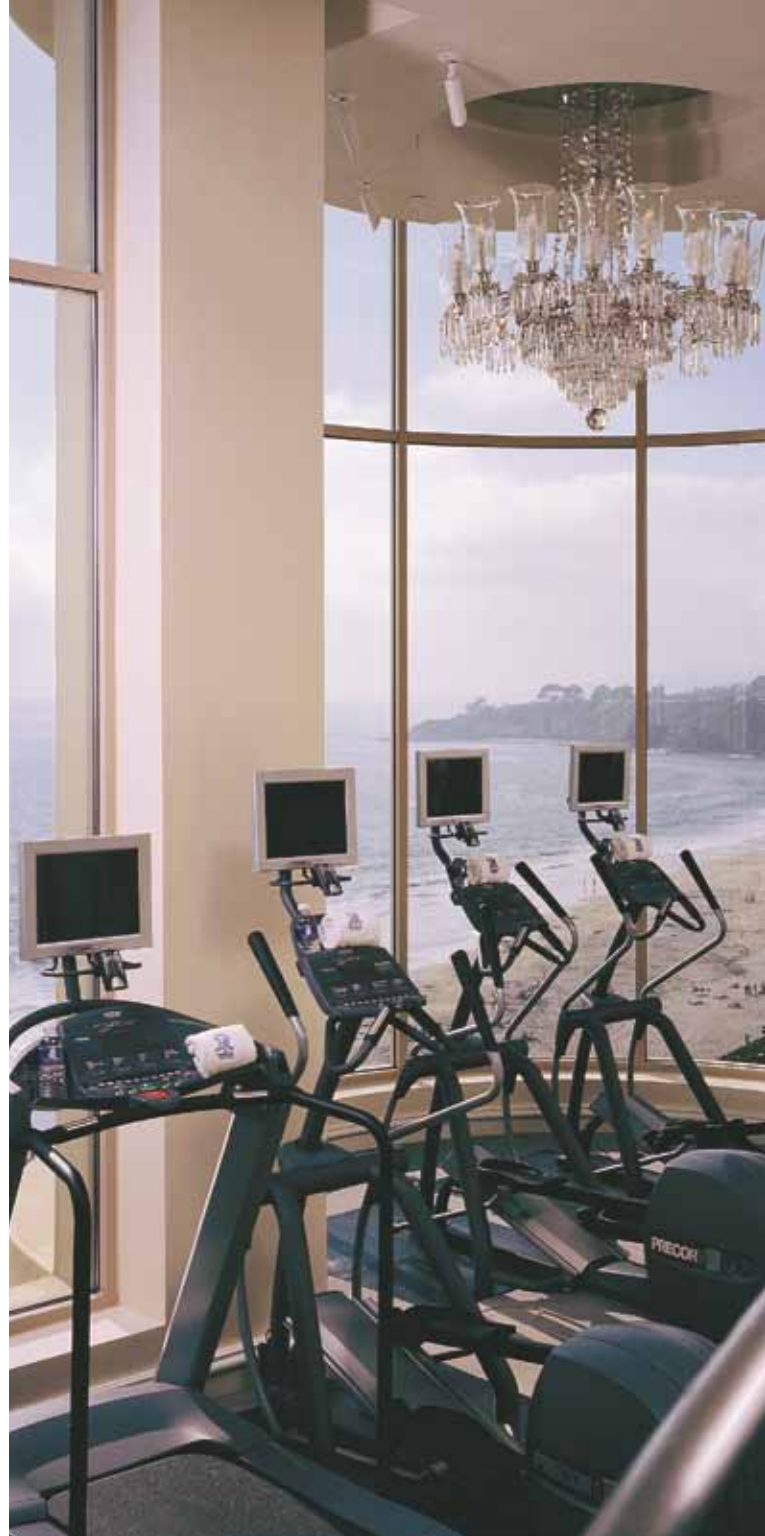

REFRESH

Tranquil water features and a menu of sea-inspired services highlight the refreshing and relaxing experiences awaiting event guests at The Ritz-Carlton Spa®, Laguna Niguel. Eleven serenely appointed treatment rooms are dedicated to enhancing mind, body and spirit. In the two-story Fitness Center, panoramic views of the Pacific Ocean complement each exercise session. State-of-the-art cardiovascular and strength-training equipment, a free-weight area and personal audio-visual services provide a wealth of options during breaks in conference schedules.

EXPLORE

- Unlimited, world-class surfing experiences
- Dana Point, whose offshore waters provide abundant opportunities for sailing, sportfishing, stand up paddling and year-round whale watching
- Dana Point Harbor, where two magnificent tallships reside in one of the most spectacular man-made harbors in the world
- Eco-Adventure Center, featuring an environmental and cultural education center with excursions lead by expert naturalists
- Golfing at the oceanside Monarch Beach Golf Links adjacent to the resort, plus seven other unique Orange County courses in the near vicinity
- Mission San Juan Capistrano, a historic church from the 1700s featuring 10 acres of gardens, fountains and historic structures
- Laguna Beach artists' colony, a cluster of more than 70 art galleries and boutiques
- Laguna Playhouse, the West Coast's oldest continuously operating theatre company
- Temecula Wine Region, where 20 quaint boutique wineries offer tours, tastings and food
- Catalina Island, a land of enchantment and beauty 22 miles off the California coast
- Knott's Berry Farm, the thrilling amusement park that evolved from a 1920s fruit stand
- Disneyland®/California Adventure®, offering entertainment, attractions and more
- LEGOLAND® California, with 5,000 LEGO® models, interactive attractions and rides
- San Diego Zoo, world-famous home to 4,000 exotic animals in natural habitats



I N Q U I R E

The Ritz-Carlton, Laguna Niguel

One Ritz-Carlton Drive • Dana Point • California 92629 USA

tel: 949-240-2000 fax: 949-240-0829 toll-free: 800-241-3333

www.ritzcarlton.com/lagunameetings



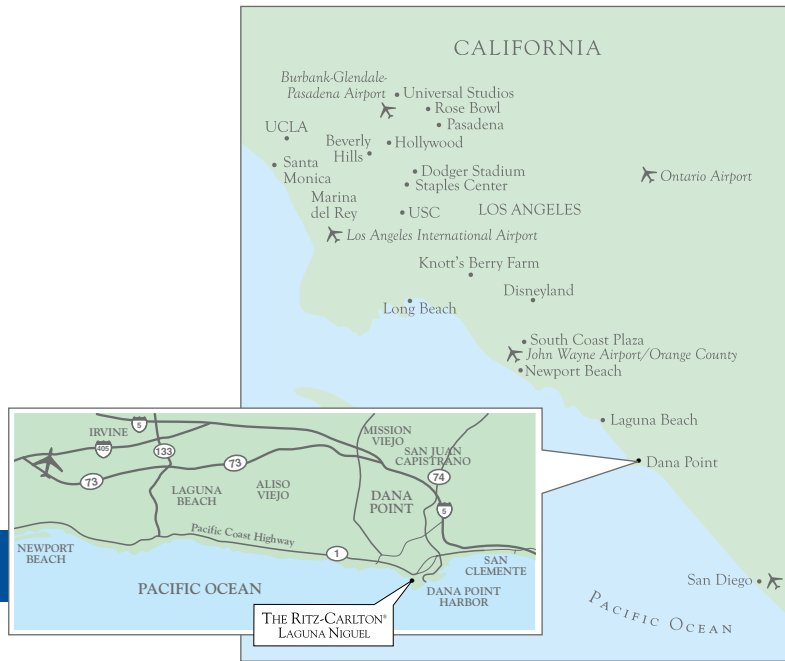

LET
US
STAY
WITH
YOU.®



THE RITZ-CARLTON®